

# LEGENDA

## VERSIONE M0 - FORATURE STANDARD DISPONIBILI M0 VERSION - STANDARD BORE OPTIONS AVAILABLE

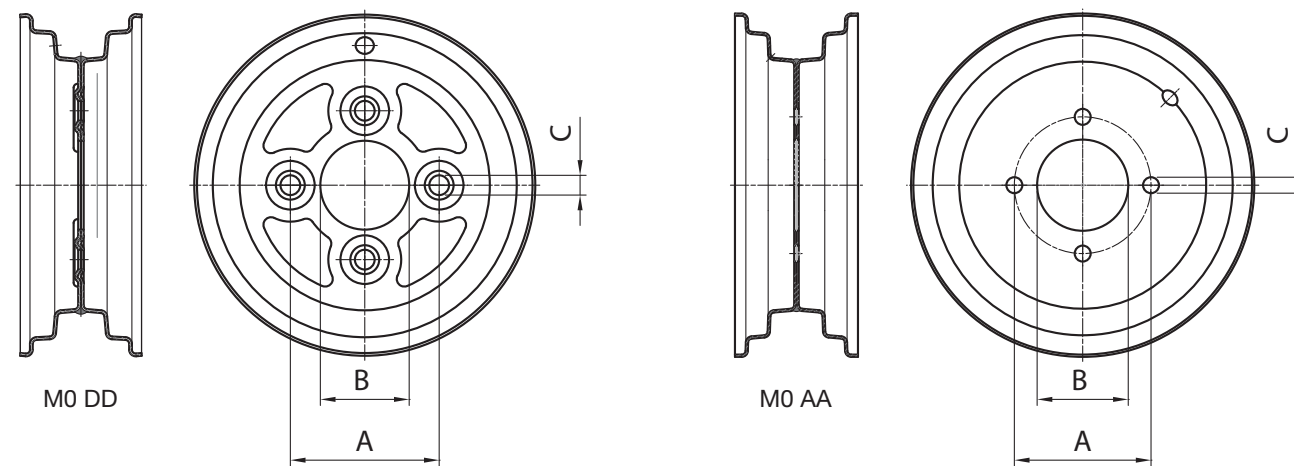

LE FORATURE STANDARD PREVEDONO LA SEDE CONICA O PIANA  
THE STANDARD FIXING HOLES FEATURE EITHER A CONICAL OR FLAT SEAT.



CODICE CODE	B	A	C	FORI HOLES	TIPO TYPE	D	NOTE
	mm	mm	mm	mm	mm		
M0 1	40,5	65	9,5	3	AA		
M0 2	70	88	8,5	3	AA		3 FORI LEM
M0 3	70	88	10,5	3	AA		
M0 4	52	70	11	4	AA		VESPA
M0 5	55	85	13	4	AA		TOPOLINO
M0 6	58	98	13	4	AA		FIAT
M0 7	58	98	13,5	4	DD	90°	FIAT
M0 8	60	100	15	4	DD	60°	BMW
M0 9	60,4	101,6	13,5	4	AA		
M0 10	62	95	13	4	AA		BALILLA
M0 11	62	95	13,5	4	DD	90°	BALILLA
M0 12	64	100	15	4	DD	60°	
M0 13	85	115	12	4	DD	90°	FRANCIA
M0 14	85	130	15	4	AA		
M0 15	94	140	18,5	5	AA		5 FORI I.
M0 16	94	140	18,5	5	DD	90°	5 FORI I.
M0 17	106	140	18,5	5	DD	90°	5 FORI I.
M0 18	161	205	18,5	6	DD	90°	6 FORI I.

## VERSIONI STANDARD

## STANDARD VERSIONS

### VERSIONE M1 M1 VERSION

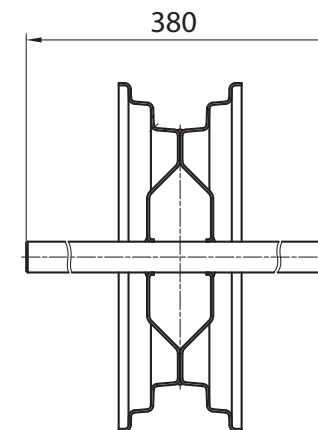

ALBERINO SALDATO Ø20  
WELDED AXLE Ø20

CODICE CODE	D	L
	mm	mm
M2 1	20	75
M2 2	20	80
M2 3	25	80
M2 4	30	80

### VERSIONE M2 M2 VERSION

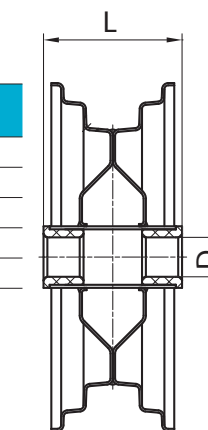

MOZZO CON BOCCOLE NYLON  
HUB WITH NYLON BUSHINGS

### VERSIONE M2R M2R VERSION

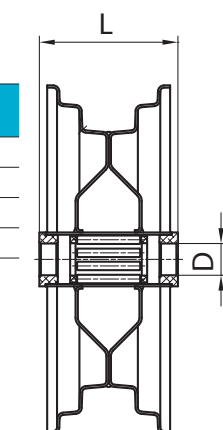

MOZZO CON CUSCINETTO A RULLI  
HUB WITH ROLLER BEARINGS

CODICE CODE	D	L
	mm	mm
M2R 1	20	75
M2R 2	25	80
M2R 3	25	100

### VERSIONE M3 M3 VERSION

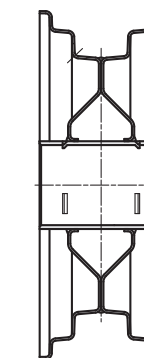

MOZZO SEDI CUSCINETTI  
HUB WITH Ball bearings SEAT

CODICE CODE	D	L
	mm	mm
M4 1	20	51
M4 2	20	80
M4 3	25	51
M4 4	25	80
M4 5	30	66

### VERSIONE M4 M4 VERSION

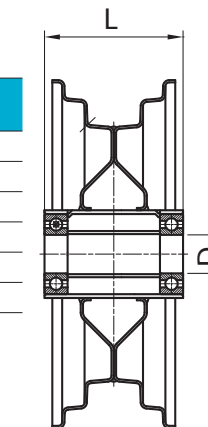

MOZZO CON CUSCINETTI A SFERA  
HUB WITH Ball bearings

### VERSIONE M5 M5 VERSION

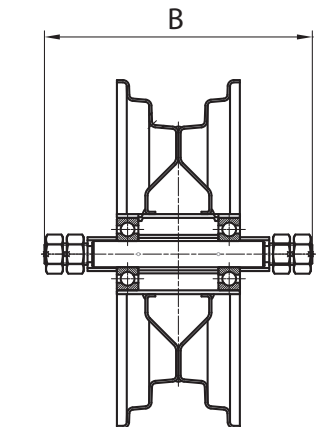

CUSCINETTI A SFERA + PERNO M14  
BALL BEARINGS + M14 AXLE

### VERSIONE M6 M6 VERSION

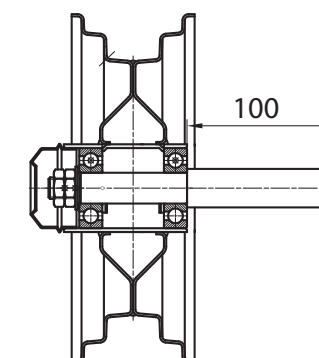

PERNO LATERALE Ø25  
SIDE AXLE Ø25

### VERSIONE TC TC VERSION

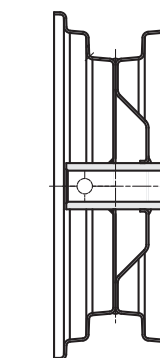

TUBO CILINDRICO CON FORO SPINA  
CYLINDRICAL TUBE WITH PINHOLE

### VERSIONE TCH TCH VERSION

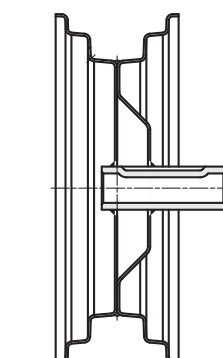

TUBO CILINDRICO CON SEDE CHIAVETTA  
CYLINDRICAL TUBE WITH KEYWAY